

Brand Powered by >>>

Sensotech

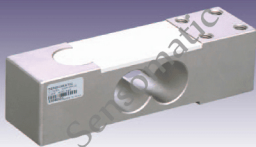

Model SSP-PF-L

WIRING SCHEMATIC	
COLOUR CODE	CONNECTION
RED	EXCITATION (+)
BLACK	EXCITATION (-)
GREEN	OUTPUT (+)
WHITE	OUTPUT (-)
SHIELD	GROUND

CAPACITY RANGE: 100 TO 1000 KGF									
CAPACITY KGF	A	B	C	D	E	F	G	H	T
SSP 100-1000	200	40	50	50	25	35	10	7.5	M 8 X 1.25

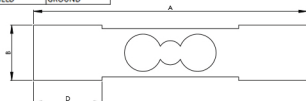

Performance Data

Capacity Range (in kgf)	100/200/300/500/750/1000
Capacity Range (in lf)	
Nominal Sensitivity (mV/V)	2±10%
Zero Signal Tolerance	0±3%
Input Resistance	415±15Ω
Output Resistance	350±3Ω
Recommended Excitation Voltage	10 VDC
Maximum Excitation Voltage	15 VDC
Linearity Deviation (as % of Full Scale)	<±0.020
Repeatability (as % of Full Scale)	<±0.020
Hysteresis (as % of Full Scale)	<±0.020
Creep (as % of Full Scale) in 30 min	<±0.020
Effect of Temperature on Zero(% / o C)	±0.002
Effect of Temp. on Span (% / o C of Load)	±0.001
Compensated Temperature Range	-10 to + 40°C
Operating Temperature Range	-20 to +70°C
Combined Error (as % of Full Scale)	<±0.023 max
Isolation Resistance (@ 50 VDC)	>1000 M Ω
Max. Limit Force (as % of Full Scale)	150
Breaking Force (as % of Full Scale)	300
Lateral Load Limit (as % of Full Scale)	
Protection Class	IP 67
Material of Construction	High Nickel Alloy Steel

Features

- Low Creep
- Excellent Overload Capability
- Low Profile Design
- Rust Proof Plating

Optional

Explosion Proof Version Suitable for Group I, IIA, IIB, IIC, & meets Temperature Class T4

Application

Low Profile Bench Scale Floor Scale Platform Scale, Concrete

Sensotech: No. 2/675, "The Palms" 1st Cross Street, Ranga Reddy Garden, Neelankarai, Chennai - 600 041.

(91)-(44)-2449 4305
 (91)-(44)-6050 4460

(91)-73057 16667 (91)-98848 69600
 (91)-93805 60667 (91)-93424 78988

sales@sensomaticloadcell.in
 sensotechindia@gmail.com
 sensotech@vsnl.net

www.sensomaticloadcell.in
 www.sensomaticloadcell.com
 www.sensomaticloadcell.net