

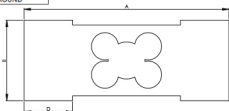

Model SSP-PF-J

WIRING SCHEMATIC	
COLOUR CODE	CONNECTION
RED	EXCITATION (+)
BLACK	EXCITATION (-)
GREEN	OUTPUT (+)
WHITE	OUTPUT (-)
SHIELD	GROUND



CAPACITY KGF	CAPACITY RANGE: 1500 TO 2000 KGF								
	A	B	C	D	E	F	G	H	T
SSP 1500-2000	190	74	74	45	35	80	10	12	M 12 X 1.75



## Performance Data

Capacity Range (in kgf)	1500 / 2000
Capacity Range (in tf)	
Nominal Sensitivity (mV/V)	2±10%
Zero Signal Tolerance	0±3%
Input Resistance	415±15Ω
Output Resistance	350±3Ω
Recommended Excitation Voltage	10 VDC
Maximum Excitation Voltage	15 VDC
Linearity Deviation (as % of Full Scale)	<±0.020
Repeatability (as % of Full Scale)	<±0.020
Hysteresis (as % of Full Scale)	<±0.020
Creep (as % of Full Scale) in 30 min	<±0.020
Effect of Temperature on Zero( % / o C)	±0.002
Effect of Temp. on Span (% / o C of Load)	±0.001
Compensated Temperature Range	-10 to +40°C
Operating Temperature Range	-20 to +70°C
Combined Error (as % of Full Scale)	<±0.023 max
Isolation Resistance (@ 50 VDC)	>1000 M Ω
Max. Limit Force (as % of Full Scale)	150
Breaking Force (as % of Full Scale)	300
Lateral Load Limit (as % of Full Scale)	
Protection Class	IP 67
Material of Construction	High Nickel Alloy Steel

## Features

- Low Creep
- Excellent Overload Capability
- Low Profile Design
- Rust Proof Plating

## Optional

Explosion Proof Version Suitable for Group I, IIA, IIB, IIC, & meets Temperature Class T4

## Application

Platform scale / Concrete Batching Plant

