

Brand Powered by >>>

Sensotech



Model ASP-PF

WIRING SCHEMATIC	
COLOUR CODE	CONNECTION
RED	EXCITATION (+)
BLACK	EXCITATION (-)
GREEN	OUTPUT (+)
WHITE	OUTPUT (-)
SHIELD	GROUND

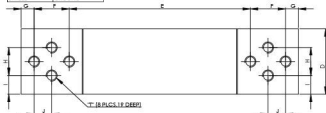

CAPACITY RANGE 60 TO 100 KGF

CAPACITY KGF	A	B	C	D	E	F	G	H	I	J	T
ASP-PF 60-100	150	38	33	35	98	19	7	15	10	9.5	M 8 X 1

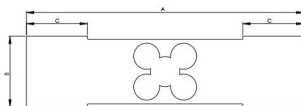

### Performance Data

Capacity Range (in kgf)	60/100
Nominal Sensitivity (mV/V)	2+/-10%
Zero Signal Tolerance	0 ± 3%
Input Resistance	415±15 Ω
Output Resistance	350 ± 3 Ω
Recommended Excitation Voltage	10 VDC
Maximum Excitation Voltage	15 VDC
Linearity Deviation (as % of Full Scale)	< ± 0.017
Repeatability (as % of Full Scale)	< ± 0.017
Hysteresis (as % of Full Scale)	< ± 0.017
Creep (as % of Full Scale) in 30 min	< ± 0.020
Effect of Temperature on Zero( % / ° C)	± 0.002
Effect of Temp. on Span ( % / ° C of Load)	± 0.001
Compensated Temperature Range	-10 to + 40°C
Operating Temperature Range	-20 to + 70°C.
Combined Error (as % of Full Scale)	< ± 0.023 max
Isolation Resistance (@ 50 VDC)	> 1000 M Ω
Max. Limit Force (as % of Full Scale)	150
Breaking Force (as % of Full Scale)	300
Lateral Load Limit (as % of Full Scale)	
Protection Class	IP 65
Material of Construction	Aluminum Alloy

### Features

- Low Creep
- Excellent Overload Capability
- Low Profile Design

### Application

Low Profile bench scale  
Floor Scale / Packaging machine

**Sensotech:** No. 2/675, "The Palms" 1st Cross Street, Ranga Reddy Garden, Neelankarai, Chennai - 600 041.

  
+ (91)-(44)-2449 4305  
+ (91)-(44)-6050 4460

  
+ (91)-73057 16667 + (91)-98848 69600  
+ (91)-93805 60667 + (91)-93424 78988

  
sales@sensomaticloadcell.in  
sensotechindia@gmail.com  
sensotech@vsnl.net

  
www.sensomaticloadcell.in  
www.sensomaticloadcell.com  
www.sensomaticloadcell.net