

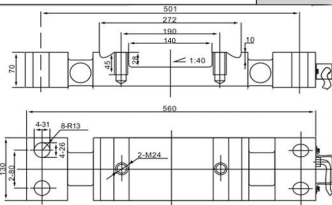

Brand Powered by >>>

**Sensotech**

**DESB - RIM**



| WIRING SCHEMATIC |                |
|------------------|----------------|
| COLOUR CODE      | CONNECTION     |
| RED              | EXCITATION (+) |
| BLACK            | EXCITATION (-) |
| GREEN            | OUTPUT (+)     |
| WHITE            | OUTPUT (-)     |
| SHIELD           | GROUND         |

**Performance Data**

|                                           |                         |
|-------------------------------------------|-------------------------|
| Capacity Range (in t f )                  | 15 / 20                 |
| Nominal Sensitivity (mV/V)                | 1±10%                   |
| Zero Signal Tolerance                     | 0±1%                    |
| Input Resistance                          | 750±10Ω                 |
| Output Resistance                         | 700±10Ω                 |
| Recommended Excitation Voltage            | 12 VDC                  |
| Maximum Excitation Voltage                | 15 VDC                  |
| Linearity Deviation (as % of Full Scale)  | ± 0.03%                 |
| Repeatability (as % of Full Scale)        | ± 0.05%                 |
| Hysteresis (as % of Full Scale)           | ± 0.05%                 |
| Creep (as % of Full Scale) in 30 min      | ± 0.03%                 |
| Effect of Temperature on Zero( % / o C)   | ± 0.05%                 |
| Effect of Temp. on Span (% / o C of Load) | ± 0.05%                 |
| Compensated Temperature Range             | -10 to+40°C             |
| Operating Temperature Range               | -10 to+40°C             |
| Combined Error (as % of Full Scale)       | ±0.3% max               |
| Isolation Resistance (@ 50 VDC)           | >1000 M Ω               |
| Max. Limit Force (as % of Full Scale)     | 150                     |
| Breaking Force (as % of Full Scale)       | 200                     |
| Lateral Load Limit (as % of Full Scale)   |                         |
| Protection Class                          | IP 68                   |
| Material of Construction                  | High Nickel Alloy Steel |

**Features**

- Low Creep
- Excellent Overload Capability
- High Fatigue Rated

**Application**

Rail Weighing

**Sensotech:** No. 2/675, "The Palms" 1st Cross Street, Ranga Reddy Garden, Neelankarai, Chennai - 600 041.

(91)-(44)-2449 4305  
 (91)-(44)-6050 4460

(91)-73057 16667 (91)-98848 69600  
 (91)-93805 60667 (91)-93424 78988

sales@sensomaticloadcell.in  
 sensotechindia@gmail.com  
 sensotech@vsnl.net

www.sensomaticloadcell.in  
 www.sensomaticloadcell.com  
 www.sensomaticloadcell.net